

**ELECTRONIC BULK TRANSFER UNIT**

**EBTU**

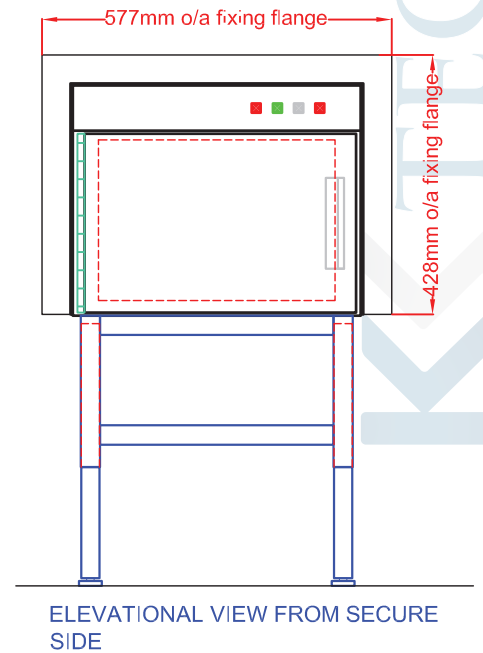
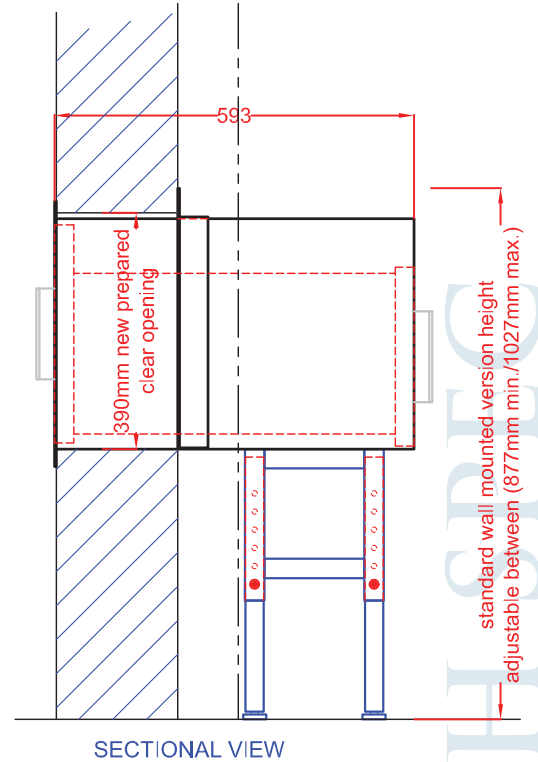
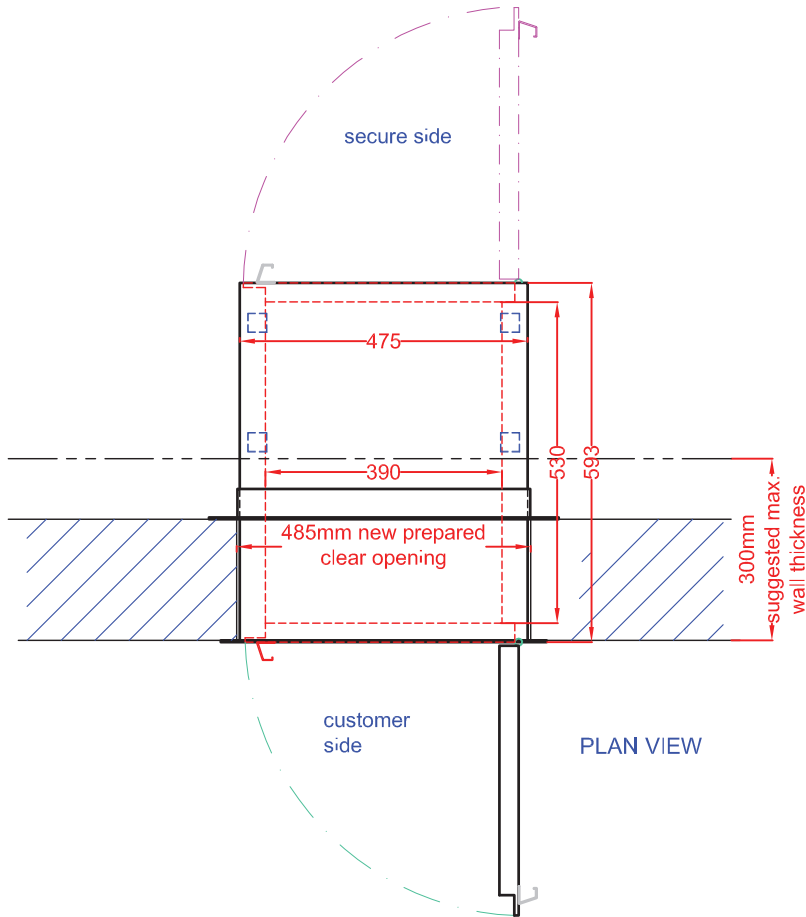

**ELECTRONIC BULK TRANSFER UNIT**  
**(Ref: EBTU)**

- Doors electronically interlocked
- 13 amp socket outlet required (by others)
- Secure to G2 S86
- Can be wall or counter mounted
- Left or right hand versions available

**FINISH**

- Brushed Stainless Steel door to customer side
- Painted Mild Steel Grey Texture